

## Our versatile hook-and-loop table straps Imaging *or* Surgical

Call for  
custom sizes!



Soft and strong.  
Trim to any length—  
four widths available!

- Radiolucent for O.R. and Imaging environments
- Versatile—available in multiple widths and lengths
- Single-patient-use for infection control

### Universal Table Straps

Extraordinarily strong, highly versatile, and pre-configured to match your table, allowing you to quickly and safely secure patients during any procedure. The red hook side adheres to either side of the soft blue loop for a strong hold that is safe against skin. Disposable for fast, easy cleanup and to help reduce cross-contamination risk. Easily shorten the **one-closure** strap by overlapping or trimming the blue loop. With **two closures**, secure smaller patients by cinching up the side rail ends. **Three-closure** strap allows for quick and easy patient access.

### Pre-configured to match your table and save you time!

#### A. Simplest

One-piece • One closure  
Encircles patient and table

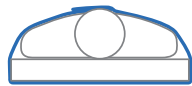

One closure

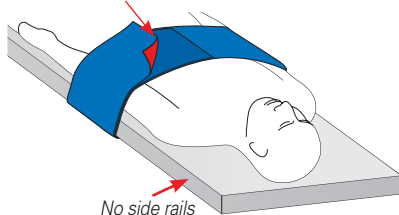

No side rails

#### B. Strongest

One-piece • Two closures  
Loops through side rails

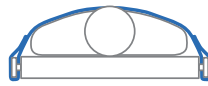

Two closures

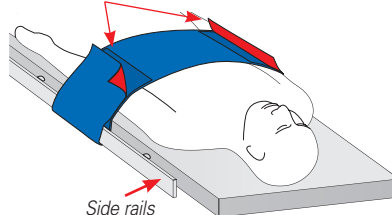

Side rails

#### C. Easy Rapid Patient Access

Two-piece • Three closures  
Loops through side rails

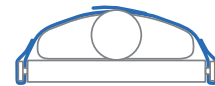

Three closures

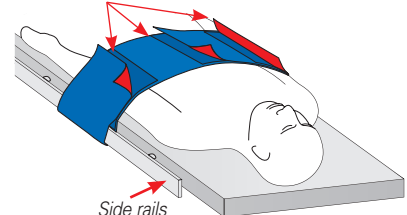

Side rails

# Universal Table Straps

■ Soft against skin

■ Versatile

■ Strong

Pre-configured to match your table and save you time!

## A. Simplest

One-piece • One closure  
Encircles patient and table

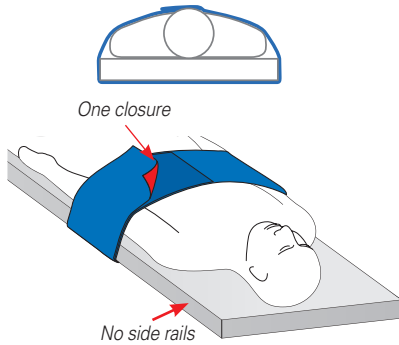

## B. Strongest

One-piece • Two closures  
Loops through side rails

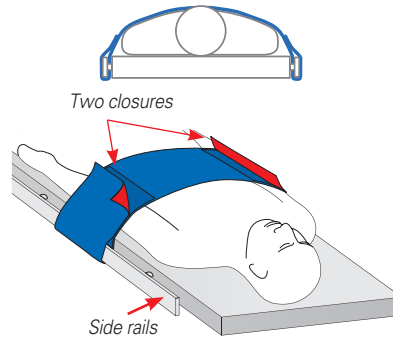

## C. Easy Rapid Patient Access

Two-piece • Three closures  
Loops through side rails

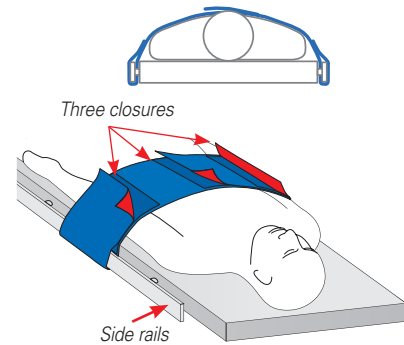

### A. SIMPLEST

ITEM #	W x L	ITEM #	W x L
#91-277	2" x 76"	#91-279	4" x 76"
#91-281	2" x 96"	#91-283	4" x 96"
#932579	2" x 108"	#932581	4" x 108"
#91-278	3" x 76"	#91-280	6" x 76"
#91-282	3" x 96"	#91-284	6" x 96"
#932580	3" x 108"	#932582	6" x 108"

### B. STRONGEST

ITEM #	W x L	ITEM #	W x L
#932570	2" x 76"	#91-598	4" x 65"
#932571	2" x 96"	#932575	4" x 96"
#932572	2" x 108"	#932576	4" x 108"
#91597	3" x 65"	#91-599	6" x 65"
#932573	3" x 96"	#932577	6" x 96"
#932574	3" x 108"	#932578	6" x 108"

### C. EASY RAPID PATIENT ACCESS

ITEM #	W x L
#91-285	2" x 47"-76"
#91-286	3" x 47"-76"
#932584	3" x 76"-108"
#91-287	4" x 47"-76"
#932585	4" x 76"-108"
#91-288	6" x 47"-76"
#932586	6" x 76"-108"

## A strap for every need

### Surgical Straps



### Armboard Straps



### Specialty Straps



Visit [AliMed.com/straps](http://AliMed.com/straps) for our complete line of straps.



**Custom** to *YOUR* specifications

Simple ordering and fast turnaround @ [AliMed.com/custom](http://AliMed.com/custom)

Any order placed before 3 p.m. EST, if in stock, ships the same day!

Prices, product availability, and specs are subject to change.

Pub. #7494REV0419 Product #11396

©2019 AliMed® Inc. All rights reserved. • Printed in USA.